

Double Shear Beam Load cell *D51S*



Features

- ▶ Material: Alloy steel, nickel-plated
- ▶ Nominal load: 10,000 - 30,000 kg
- ▶ Construction: The measuring element is laser-welded
- ▶ Protection class: IP66
- ▶ Simple mounting
- ▶ Particularly robust for tough continuous use in industrial environments
- ▶ Compatible with other manufacturers



Scope of application:

- ▶ On-board weighing systems - On board weighing
- ▶ Refuse collection vehicles and collection lorries
- ▶ In test stands
- ▶ To accommodate storage racks

Double Shear Beam Load cell D51S

Double shear beam load cells with parallel load introduction

The D51S is a double shear beam load cell with parallel load application made from high quality alloy tool steel. This heavy duty load cell is ideal for on-board weighing, applications such as container weighing in vehicles, waste collection vehicles and removal trucks with and without trailers. The D51S vertical force sensor delivers

extremely precise and reproducible measurement results even in long-term use in harsh industrial environments. The load cell is laser-welded and meets the requirements of protection class IP66.

TECHNICAL DETAILS

Accuracy class according to OIML R 60		G3
Nominal load (E_{max})	kg	10.000, 15.000, 20.000, 30.000
Number of division values (n_{LC})		3000
Nominal value (C_n) / Characteristic tolerance	mV/V	2,0 / $\pm 0,005$
Minimum preload (E_{min})		0
Limit load (EL)	% from E_{max}	120
Breaking load (Ed)		150
Recommended supply voltage (U_{ref})	V	5 - 12
Maximum permissible supply voltage (BU)		15
Zero adjustment	% v. C_n	$\leq \pm 1$
Input resistance (RLC) at reference temperature	Ω	750 \pm 10
Output resistance (RO) at reference temperature	Ω	702 \pm 3
Insulation resistance	M Ω	> 5 000
Nominal temperature range (BT)		- 10 ... + 40
Protection class according to (DIN 40.050 / EN 60529)		IP 66
Cable length		On request
Material		Alloy steel

TECHNICAL DRAWINGS

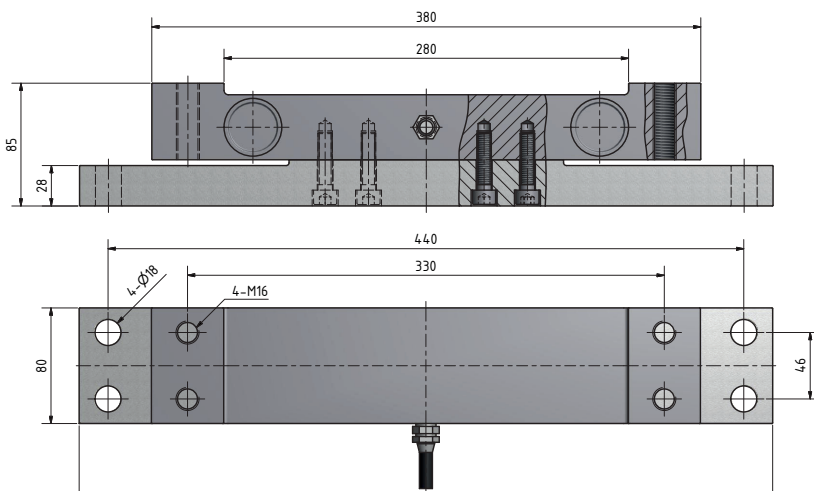

Elektrischer Anschluss 4-Leiter - Kabel

